



## High Gain Directional Panel Antenna for 2.4 ISM Band

(Model: SA2-05009-NO)

### Specifications

#### Electrical Specifications

Frequency Range	2300-2500 MHz
Gain	12 dBi
VSWR	1.5:1 max
Polarisation	Linear, vertical
HPBW / horizontal	50°
HPBW / vertical	50°
Front-to-back ratio	15 dB
Downtilt	0°
Power handling	50W (cw)
Impedance	50 Ohms
Connector	N Female or SMA Female



#### Mounting Configuration

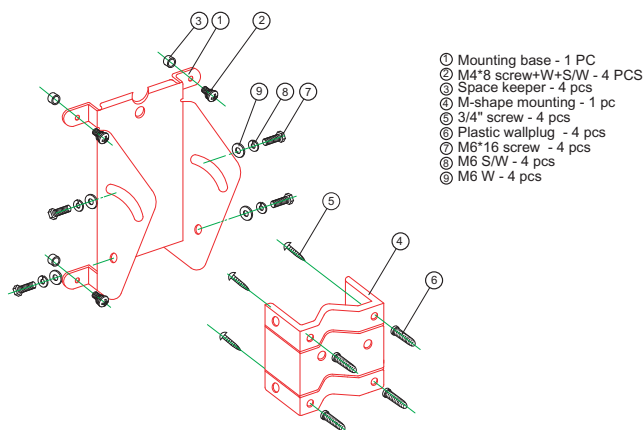

#### Environmental & Mechanical Specifications

Survival wind speed	180 km/h
Temperature	-40°C to +80°C
Humidity	100% @ 25°C
Lightning Protection	DC Ground
Radome Colour	Grey-white
Radome Material	ABS/UV Resistant, Fire Retardant
Weight	0.7 kg
Dimensions	345 x 87 x 48 mm

