

REVISIONS		
ISS	ZONE	DESCRIPTION/PER REQUEST

3rd ANGLE PROJECTION  THIS DOCUMENT AND THE DESIGN SHOWN THEREON IS THE PROPERTY OF ROJONE PTY LTD AND MUST NOT BE SOLD, LENT, GIVEN AWAY, COPIED, REPRODUCED OR OTHERWISE DIVULGED TO ANY THIRD PARTY OR USED FOR MANUFACTURE, OR ANY OTHER PURPOSE WITHOUT DIRECT WRITTEN PERMISSION OF ROJONE PTY LTD. DO NOT SCALE

A  
B  
C  
D  
E  
F  
G  
H  
I

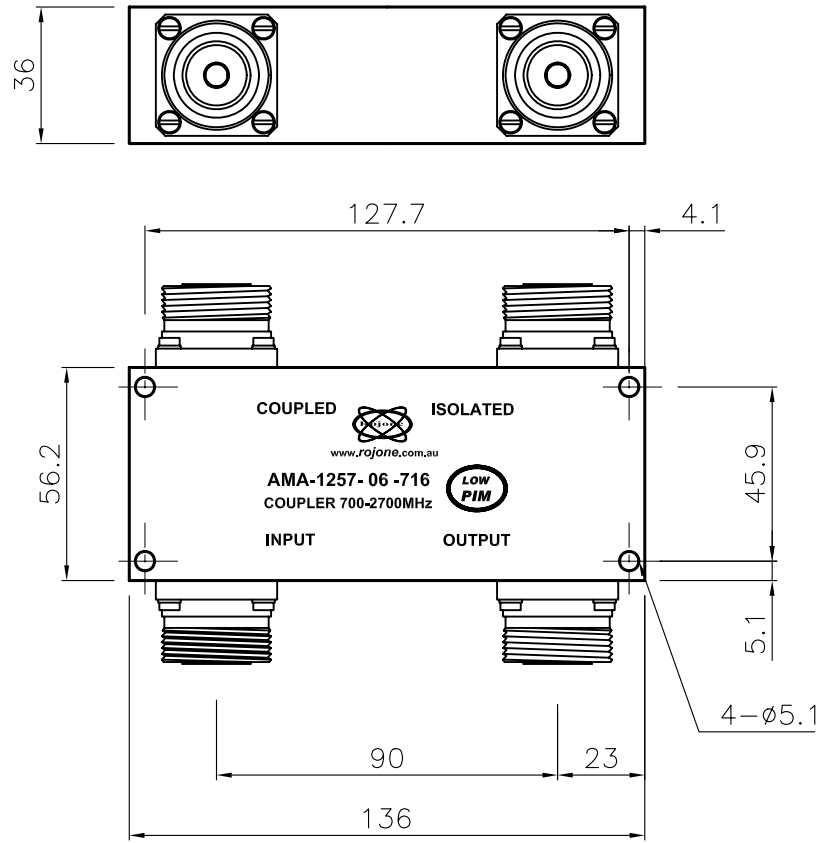

**SPECIFICATIONS for AMA-1257-XX-716**

**FREQUENCY RANGE:** 0.7-2.7GHz  
**COUPLER TYPE:** 4 PORT DIRECTIONAL  
**POWER HANDLING:** 200W CW (@25°C)  
**COUPLING VALUE:** 3,4,8,6,7,8,9,10,13,15,20,30 & 46dB  
**DIRECTIVITY:** 20dB (Typ)  
**RETURN LOSS:** <-20dB (Typ)  
**AMP BALANCE:** < ± 0.5dB  
**IM:** <-150dBc@43dBmx2

**OPERATING TEMPERATURE:** -40° TO +65° CELCIUS  
**RF CONNECTOR:** DIN 716 - F  
**Environmental Class:** IP 65  
**HUMIDITY:** <99% NO CONDENSATION  
**WEIGHT:** 820 GRAMS ALUMINIUM HOUSING (WITHOUT LOAD)  
 1700 GRAMS BRASS HOUSING (WITHOUT LOAD)

Coupling Value:	Through Loss (typ.):
3dB	3.17dB
4.8dB	1.90dB
6dB	1.41dB
7dB	1.12dB
8dB	0.90dB
9dB	0.73dB
10dB	0.61dB
12dB	0.43dB
13dB	0.37dB
15dB	0.29dB
18dB	0.22dB
20dB	0.19dB
30dB	0.15dB

**NOTES:**

- 1/ ROJONE PART No. DESIGNATION AMA-1257-XX-716  
eg. 6, 10, 15, OR 20 (COUPLING VALUE)
- 2/ UNUSED PORTS MUST BE TERMINATED WITH 50 Ohm LOADS.
- 3/ COUPLERS ARE DESIGNED FOR LOW INTERMODULATION OPERATION.
- 4/ PRODUCTS ARE RoHS COMPLIANT.

UNLESS OTHERWISE STATED ALL DIMENSIONS ARE IN MILLIMETRES (mm) TOLERANCE: LINEAR ±0.1 ANGULAR ±1° REMOVE ALL BURRS AND SHARP EDGES

	ROJONE PTY LTD ACN 002691241 44 AERO RD INGLEBURN 2565 SYDNEY, AUSTRALIA Ph: (612) 9829 1555 Fax: (612) 9605 8812 Web: www.rojone.com.au E-mail: sales@rojone.com.au	TITLE 700-2700MHz AMA-1257-XX-716 DIN-TYPE INTERFACE DRAWING	
	MATERIAL ALUMINIUM &/OR BRASS HOUSING & COVER FINISH POLYURETHANE AS2700 N42 STORM GREY	DRAWN Y. GU CHECKED H. JIA APPROVED	DRWG No: 001001450176

REVISION	DATE	CHECKED
A	16-04-2010	H. JIA

A2